

# VINEYARDS TRIMMERS CUTTER

## VINEYARDS TRIMMERS CUTTER

Thanks to its alternate cutting system, the trimmer Mower can perform clean cuts of the vineyard foliage, with high speed of advancement. Applicable to any kind of tractor to the front by purpose-built support. The frame is linked to the tractor by tie-rods for biggest safe conditions.

It can work near the soil thanks revolving shoot conveyors, one for each cutting bar. Dolmec's Trimmers frames are built of resistant section iron square tube and available into different configurations.



Description	Model
Trimmer "Mower" with single vertical bar and top	SLTC

Trimmer "Mower" with single vertical bar and horizontal top.

Equipped with:

- reciprocating blade system,
- anti-shock absorption retractable system with self setting,
- hydraulic vertical tilt adjustment,
- hydraulic width adjustment,
- directional control valves.

Pedestal for storage.



Descrizione	Modello
Trimmer "Mower" with double vertical bar	DLC

Trimmer "Mower" with double vertical bar.

Equipped with:

- reciprocating blade system,
- Anti-shock absorption retractable system with self setting,
- hydraulic vertical tilt adjustment,
- hydraulic width adjustment,
- directional control valves.

Pedestal for storage.

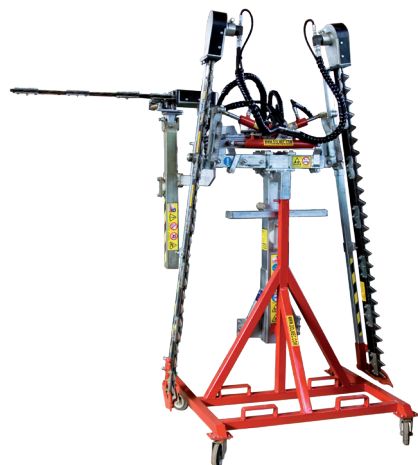

Descrizione	Modello
Trimmer "Mower" with double vertical bar and Top	DLTC

Trimmer "Mower" with double vertical bar.

Equipped with:

- reciprocating blade system,
- anti-shock absorption retractable system with self setting,
- hydraulic vertical tilt adjustment,
- hydraulic width adjustment,
- directional control valves.

Pedestal for storage.

# VINEYARDS TRIMMERS CUTTER

## DATI TECNICI

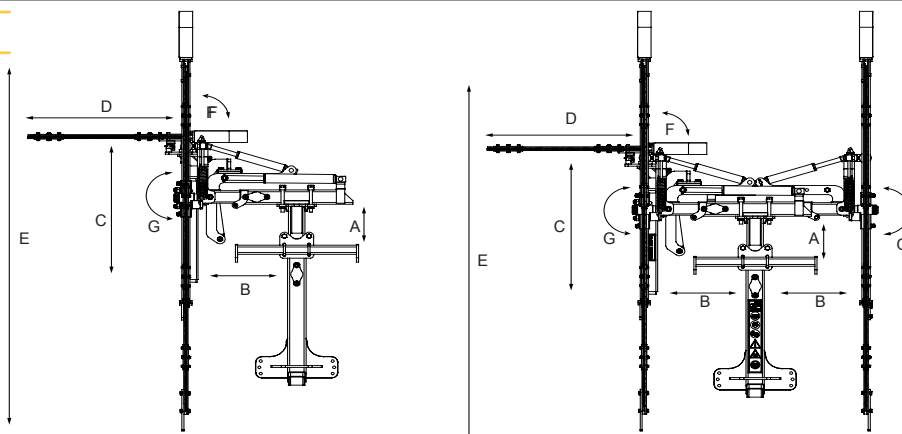

Model	A height work adjust	B dx-sx movements	C top vertical adjust	D top length	E cutting bar length	F top tilt adjust	G cutting bar tilt adjust	weight
SLTC	mm.500	mm.450	mm.450	mm. 800	mm.1750	0 /+20°	+/-15°	kg.220
DLC	mm.500	from 900 up to 1850	■	■	mm.1900	■	+/-15°	kg.250
DLTC	mm.500	from 900 up to 1850	mm.450	mm.1000	mm.1900	0 /+20°	+/-15°	kg.330

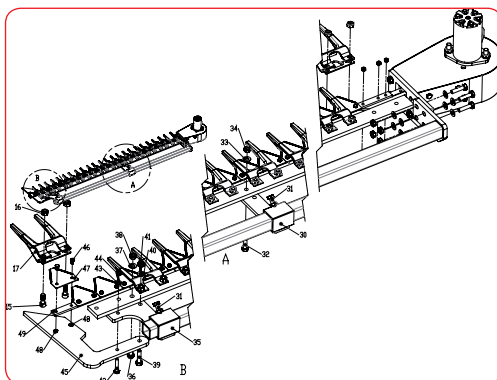
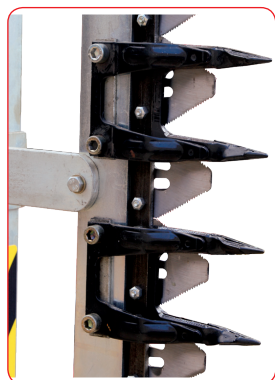

Shoots conveyors for work close to ground.

Cutting system trimmer "Cutter". Knife changing is very easily.

Height of the horizontal cutter bar, width work of the vertical cutter bars and their tilting can be adjusted manually, by directional control valves or by electronic control remote panel and joystick four axis. Vertical and horizontal cutting bars have anti-shock absorption retractable system with self setting mode.

Hydraulic requirement is 25 lt./min. Is preferred to use an independent hydraulic system. with double pumps, gears multiplier, oil filters, max pressure valve and oil cooler radiator. (optional) (60 lt capacity oil tank)

horizontal bar top

shoots conveyor

remote electronic panel

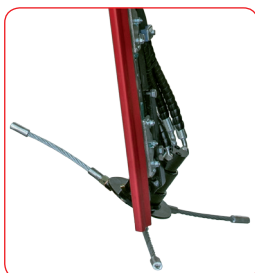

authorized dealer:

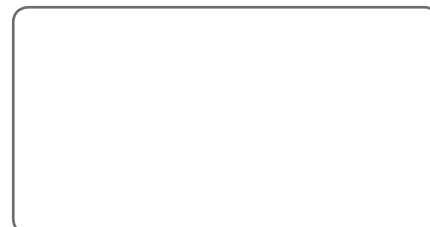

Modification can be apported without advice.